

Numerical modelling of the Low Cycle fatigue in Austenitic Stainless Steel.

Sushant B PATE, Gintautas DUNDULIS, Albertas GRYBENAS.



CONTENT

Introduction

1. Experimental LCF Test
2. Numerical Simulation of LCF
3. Results

Conclusion

- Elasto-plastic failure of the component above the yield stress occurs below 10^5 loading cycles.
- The fatigue of the steel.
- LCF is an important design consideration for metallic machine components, steel structures, and significantly influences the degradation mechanism and serving life due to which this is the hot topic for the research.
- It is very difficult to create actual reactor working environment such as extreme temperature, etc. Hence, the finite element method can be used for the investigation to estimate the fatigue behaviour of the steel.

- In the presented research, low cycle fatigue test experiment for 0.2% strain on AISI304L steel is performed and a numerical simulation is performed for the same LCF experiment. For the numerical simulation a combination of the isotropic hardening and the Chaboche kinematic hardening is used for the material modelling. The parameters for the Chaboche model for AISI 304L steel at strain amplitudes of 0.2% is estimated. For the preparation of FE model, LS-DYNA and ANSYS software's are used. The simulation results are compared with the experimental result for the validation of the numerical model.

1

KAUNAS UNIVERSITY OF TECHNOLOGY

Experimental LCF Test

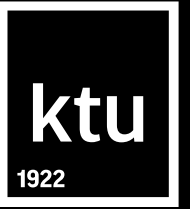

Faculty of Mechanical Engineering and Design

1.1. Material and Specimens

- Test specimen manufacturer Creusot Loire Industries
- AISI304L Steel, annealed between 0.5-2hrs for temperature between 1050°C to 1100°C.

Table 1 Mechanical properties of AISI 304L steel.

Temperature, °C	Yield Stress, MPa	Ultimate Tensile Strength, MPa	Elongation, %	Youngs Modulus, GPa
20	278	610	84	200
300	220	499	42	157

1.2. Low Cycle Fatigue Test Method

ktu

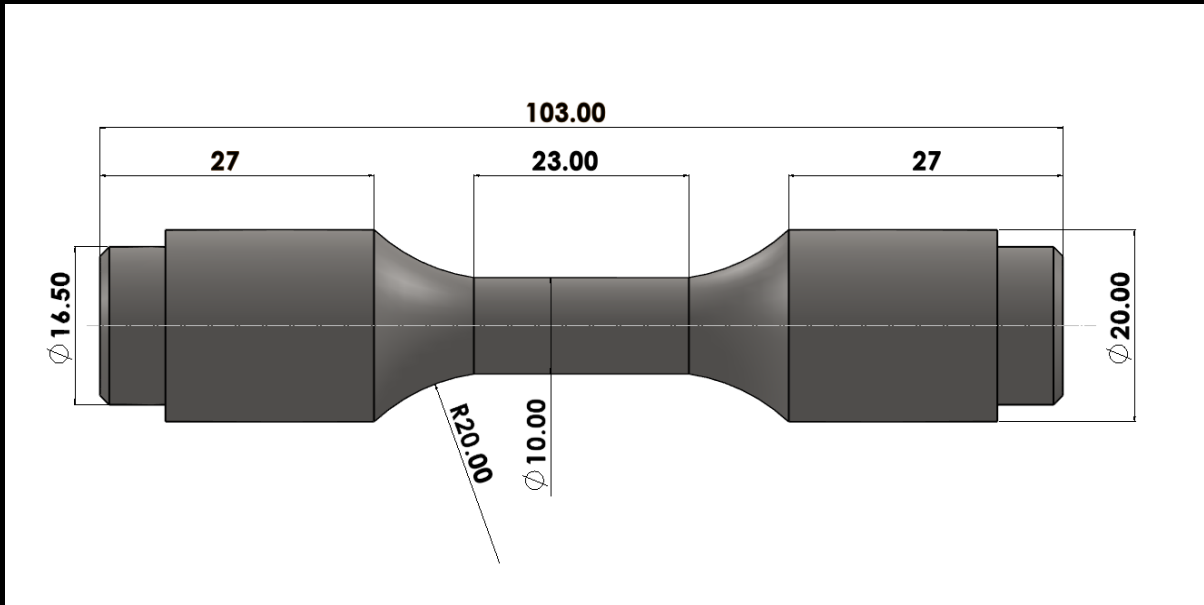

Figure 1. LCF test specimen drawing.

- The low cycle fatigue test was carried out using Instron Model 8801 at 300°C and for the strain amplitude of 0.3% .
- ASTM E606 Standard Practice for Strain-Controlled Fatigue Testing.
- This experimental were performed under the project INCEPA-PLUS for the preparation of the guidelines to improve the assessments of environmental fatigue damage.

2

KAUNAS UNIVERSITY OF TECHNOLOGY

Numerical Simulation of LCF

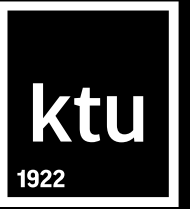

Faculty of Mechanical Engineering and Design

2.1. Finite Element Model

ktu

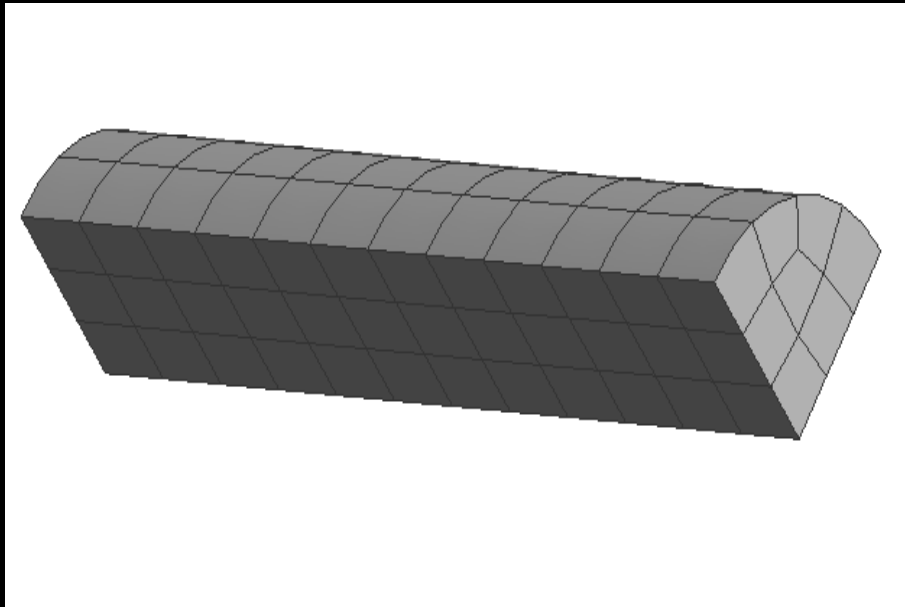

Figure 2 Finite Element Meshed Model.

LS-DYNA

- 8 node constant stress solid elements.

ANSYS

- SOLID185 element, 8-node.

All translation DOF.

2.1. Finite Element Model (2)

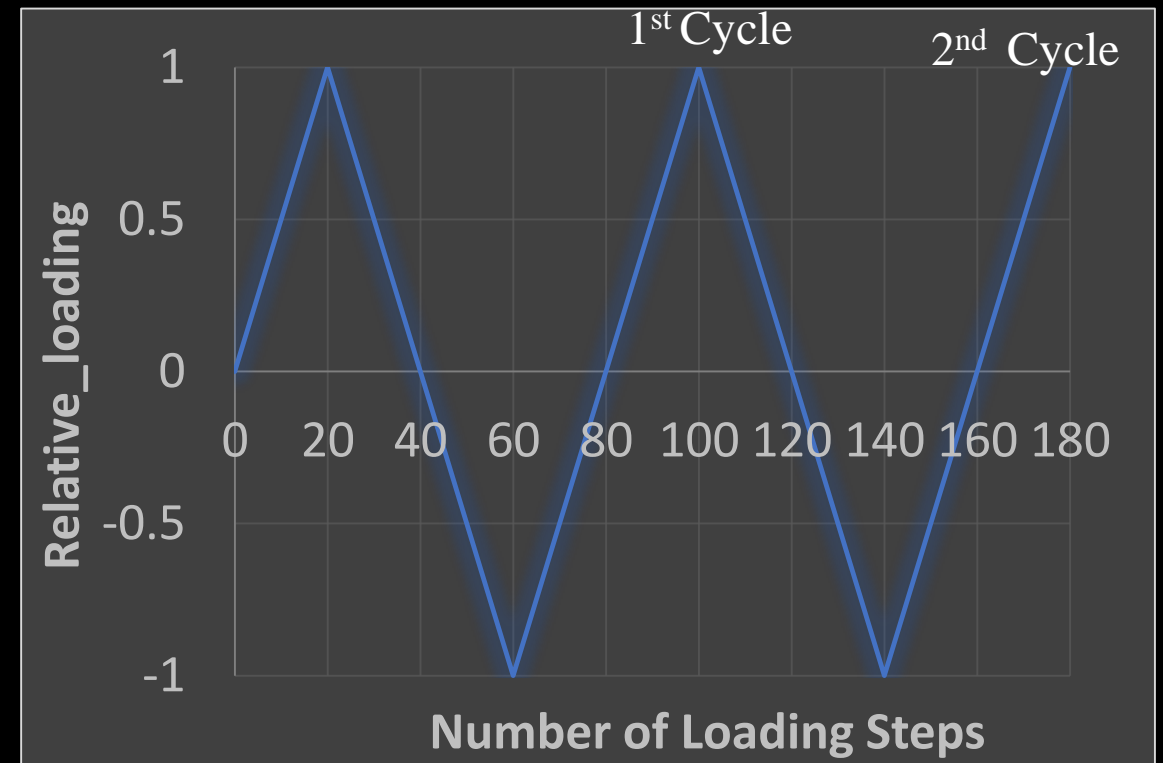
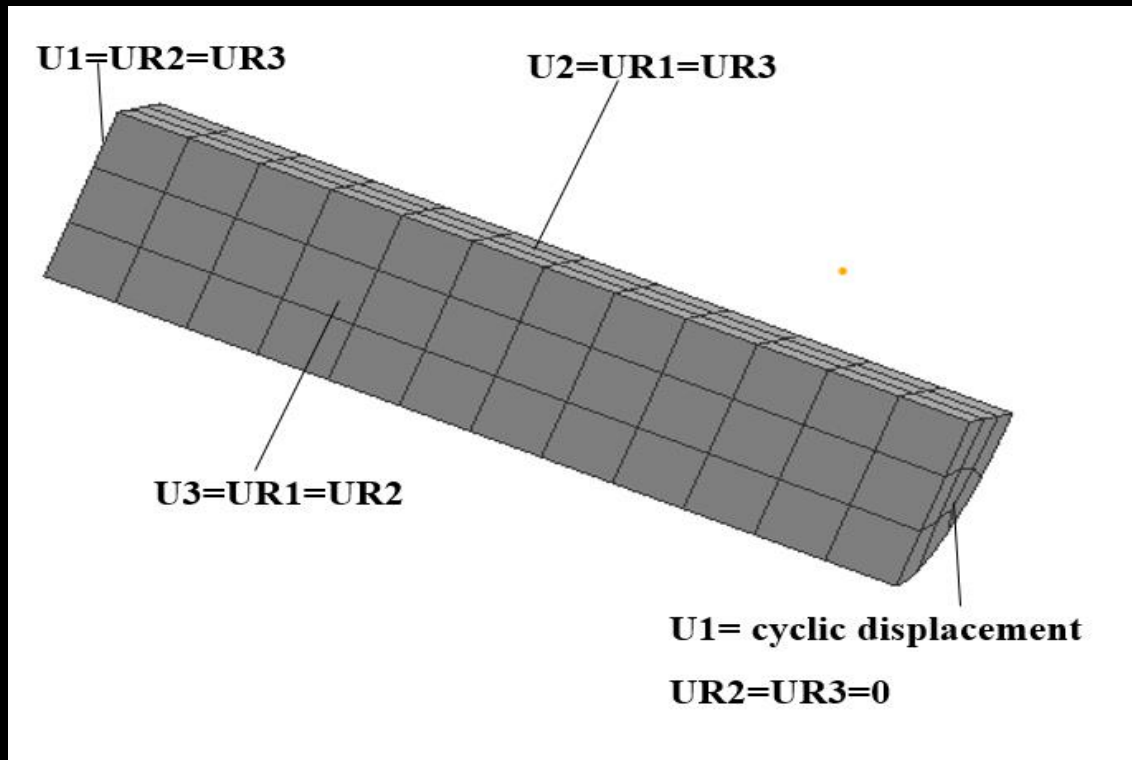

Figure 3 Applied boundary conditions for finite element model.

Figure 4 Waveform of cycle load used for numerical simulation

2.2. Material Model

Table 2. Parameters used to describe the AISI 304L Steel at 300 ° C for 0.3% strain.

Parameters	Parameter value
Youngs Modulus, E, GPa	157
Poisson's ratio ν	0.27
Yield Stress, σ_y , MPa	220

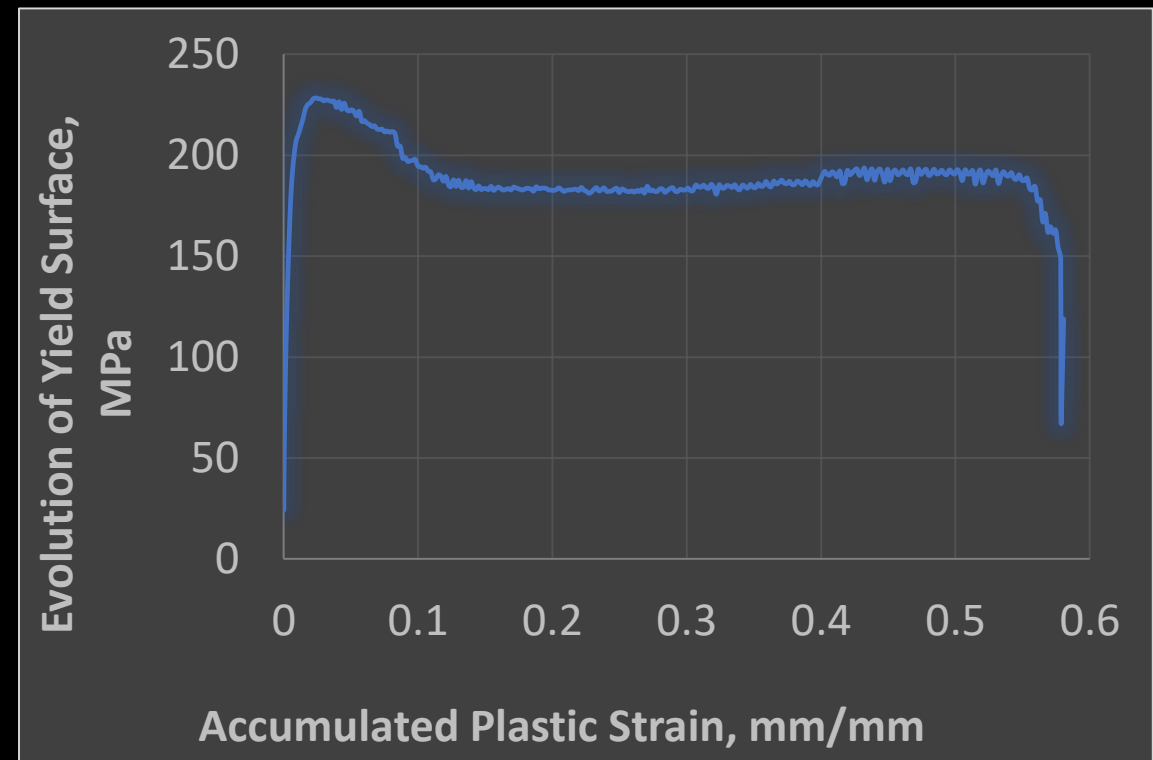

Figure 5 Isotropic Hardening Curve

2.2. Material Model (2)

Table 3. Kinematic harenig parameters estimated for the strain range of 0.3%.

	C_1 (MPa)	γ_1	C_2 (MPa)	γ_2	C_3 (MPa)	γ_3	K.H Model
LS-DYNA	195679	2750	250679	3500	375508	4500	$\dot{\alpha}_j = 2/3 C_j \dot{\epsilon}^{pl} - \gamma_j \alpha_j^{\dot{\epsilon}^{pl}}$
ANSYS	100350	2750	135180	3500	61508	1650	$d\alpha_i = \frac{2}{3} C_i d\epsilon^p - \gamma_i \alpha_i dp$

3

KAUNAS UNIVERSITY OF TECHNOLOGY

Results

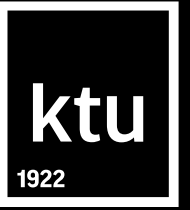

Faculty of Mechanical Engineering and Design

3.1. Experimental LCF Test

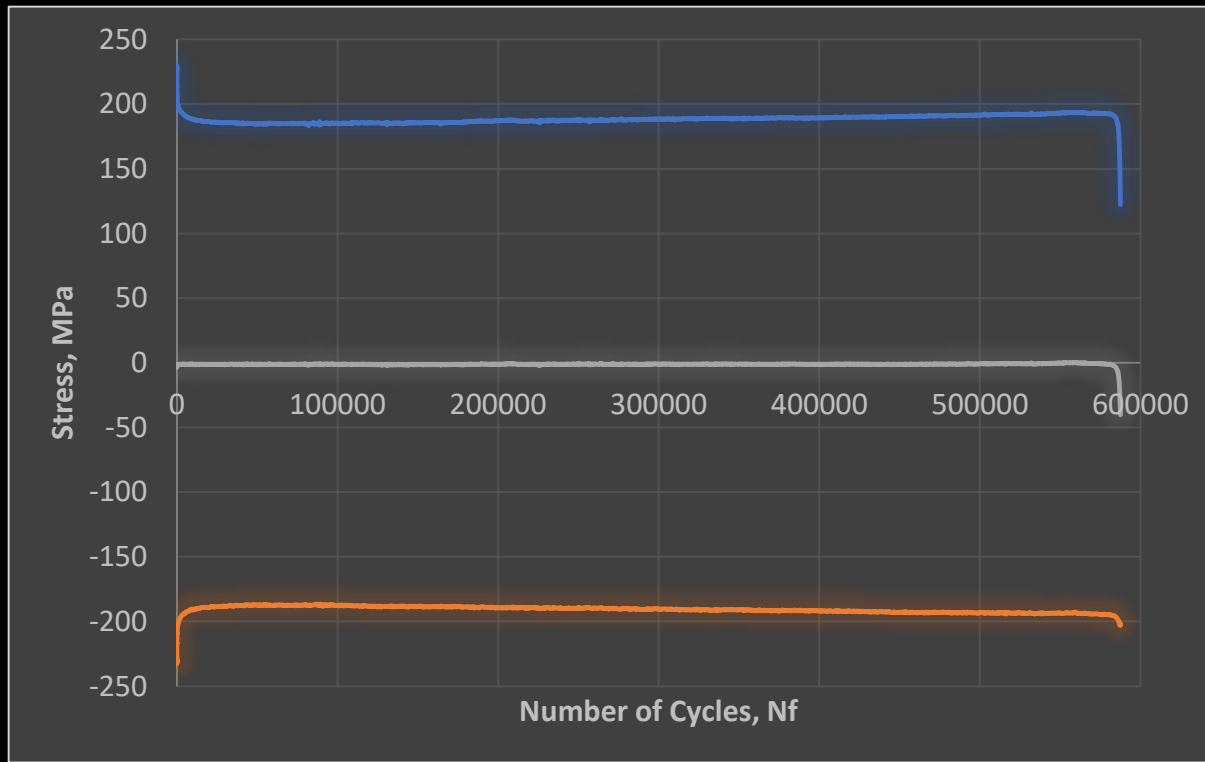

a

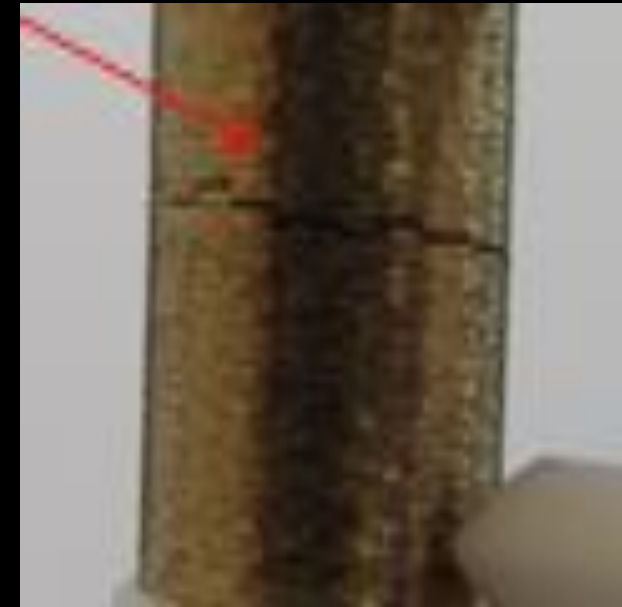

b

Figure 6. a) Maximum stress v/s number of cycles experimental results at strain amplitudes of 0.3% and b) specimen after failure

3.2. Numerical Simulation results and comparison

ktu

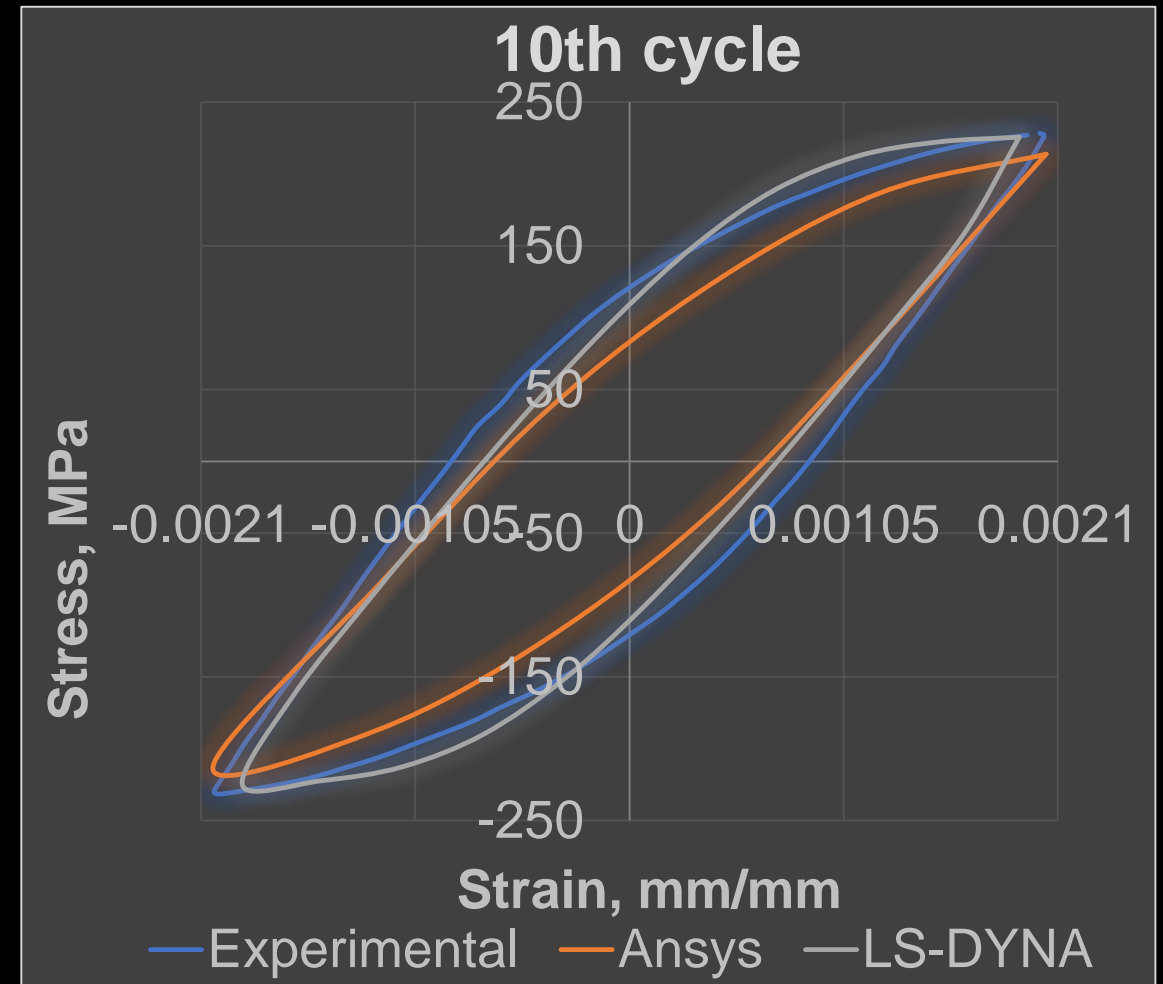
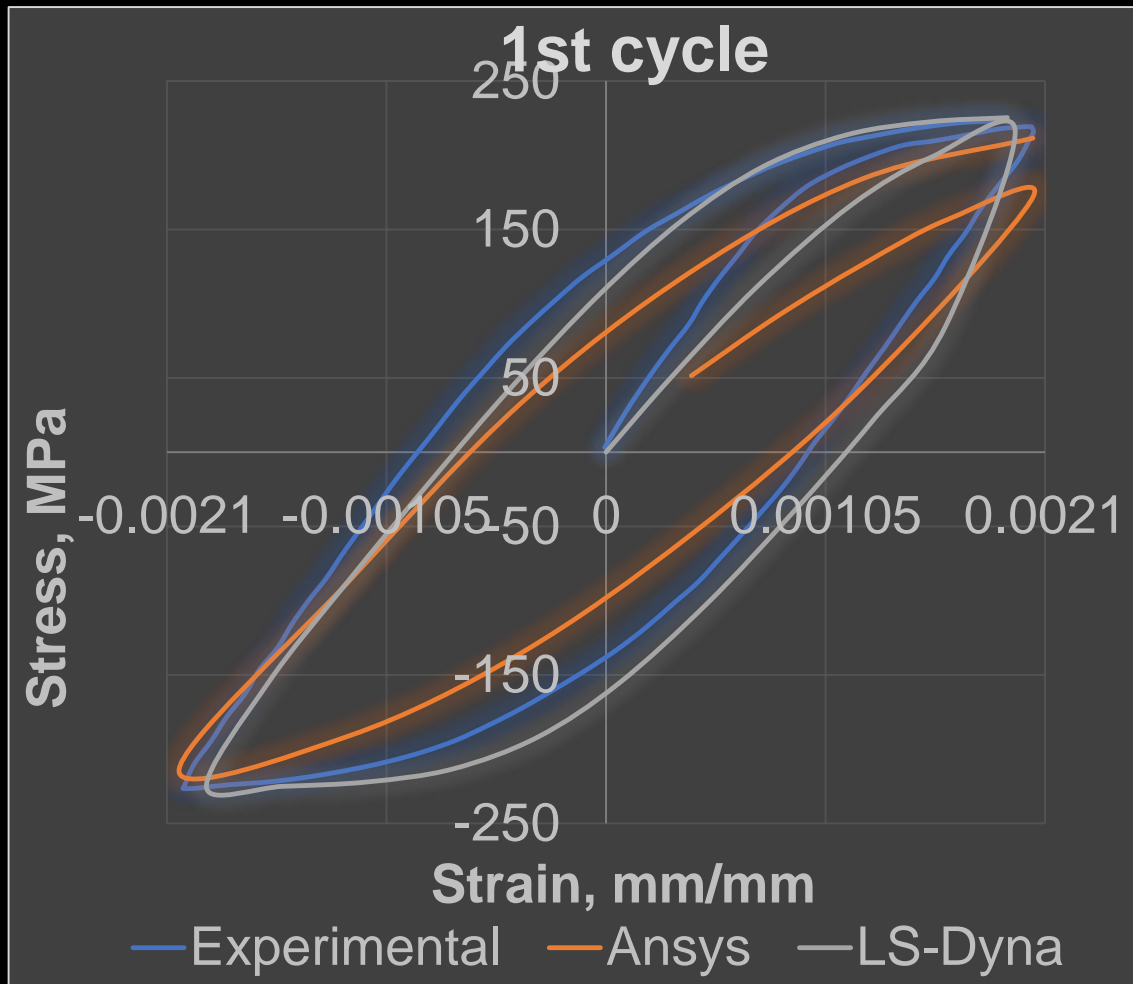

Figure 7 Stress Versus Strain curve plotted for experimental and numerical simulation results

3.2. Numerical Simulation results and comparison (2)

ktu

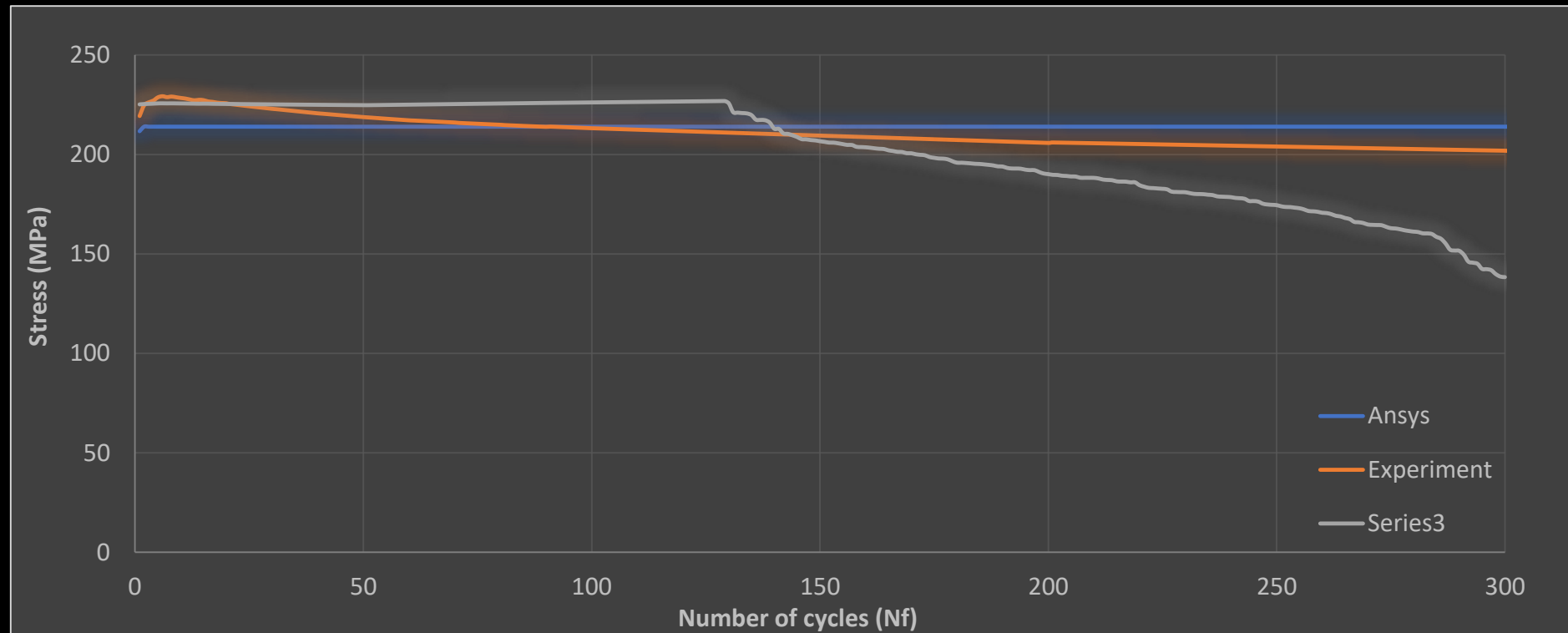

Figure 8 Maximum stress versus number of cycles curve for experimental and simulation results

1. 0.3% strain controlled LCF test and on AISI304L Steel and numerical simulation for the same are performed.
2. Cyclic softening behaviour is observed in the experimental results.
3. For the material modelling Combined Isotropic and Kinematic hardening is employed.
4. Chaboche K.H. rule for ANSYS and Armstrong and Frederick K.H rule for LS-Dyna.
5. 3.3% deflection in Ansys with Experimental Results is observed and 31% deflection in case of LS-Dyna is observed.
6. ANSYS was not able to capture the cyclic softening behaviour were as in case of LS-Dyna, it captures the softening behaviour.

7. With the improvements in the material parameters and refinement in the model for LS-Dyna can be employed for such analysis. This methodology can be employed for the LCF numerical analysis to estimate the change in the behaviour of the material with the increase in the loading cycles and to predict the approximate fatigue life of the material undergoing cyclic loading.

1. Bruchhausen, M.; Dundulis, G.; McLennan, A.; Arrieta, Sergio; Austin, T.; Cicero, R.; Chitty, W.-J.; Doremus, L.; Ernestova, M.; Grybénas, A.; Huotilainen, C.; Mann, J.; Mottershead, K.; Novotny, R.; Perosanz, F. J.; Platts, N.; le Roux, J.-C.; Spätig, P.; Celeizábal, C. T.; Twite, M.; Vankeerberghen, M. Characterization of Austenitic Stainless Steels with Regard to Environmentally Assisted Fatigue in Simulated Light Water Reactor Conditions // Metals. Basel : MDPI. ISSN 2075-4701. 2021, vol. 11, iss. 2, 307, p. 1-20. DOI: 10.3390/met11020307.
2. J.L. Chaboche, G. Rousselier. (1983) On the Plasticity and viscoplasticity Constitutive Equations—part II: Application of Internal Variable Concepts to the 316 Stainless Steel, Journal of Pressure Vessel Technology 105, pp. 159-164.
3. H. Mahbadi, M.R. Eslami. Cyclic loading of thick vessels based on the Prager and Armstrong–Frederick kinematic hardening models. International Journal of Pressure Vessels and Piping 83 (2006) 409–419



Faculty of Mechanical Engineering and Design

**Thank You for
your Attention**